

AGENDA /

5:30 - 6:00 **Arrival & Welcome**

6:00 – 6:10 **Subcommittee Follow-Up**

Rob Johns

6:10 – 6:20 **Project Update**

PPS

6:20 – 7:50 **Updated Master Plan & Site Activity**

Bassetti Architects

Mayer/Reed

7:50 – 8:00 **Public Comment**

BENSON POLYTECHNIC H.S. DAG #3 / DECEMBER 6, 2018

INTRODUCTIONS /



PORTLAND PUBLIC SCHOOLS

Jen Sohm



BASSETTI ARCHITECTS

Lorne McConachie

Joe Echeverri

Aydin Erhan



MAYER/REED

Carol Mayer-Reed

Anne Samuel

James Voelckers

Emily Kuo



SUBCOMMITTEE FOLLOW-UP / ROB JOHNS

SUBCOMMITTEE IDEA / SUGGESTIONS

Student Action Committee – supporting student outreach and engagement for meaningful input

Sustainability Committee – this group could support our effort in Eco-Charrettes and ongoing conversations about what sustainable features would be most important to the Benson staff and community

Inclusive Design Committee – help define areas and design features will best serve all students and users of the building

Industry Outreach Committee – tasked with outreach for developing long term relationships for new and continuing programs, connect the dots for design team input from interested parties, program trends, fundraising for aspects of the project

Art and Display Committee – inventory and planning of what heritage items within the building will need to be salvaged and curated, and identifying new pieces that could be incorporated

Other ideas?

PROJECT UPDATE / PORTLAND PUBLIC SCHOOLS



Design Advisory Group Worksession

- Sign in – DAG & Visitors
- Public comment: sign up for testimony
- Public comment: written comment cards
- Worksession activities are for DAG members only
 - Visitors observe activities; written comment cards
- Public comment: sign up for testimony



November 6 BOE Worksession

- Benson Polytechnic Master Plan & Ed Spec presentation
 - Jen, Joe with Kaily & Glen, DAG Co-Chairs
- Discussion points
 - Superintendent: visual/performing arts in line with comprehensive HS Ed Spec
 - CTE plan, enrollment plan missing/not complete
 - Multiple Pathways to Graduation have not been included in project yet
 - Add language around enrollment growth to resolution



Benson Tech Steering Committee

- Steering Committee request to study Benson swings to Marshall campus during construction to determine cost savings
 - This will require further study and analysis
 - Project team will need to study tenant improvement required to bring all CTE programs to Marshall
 - CMGC to help determine cost and schedule impacts of off site swing vs. occupied site



November 27 Worksession

- Staff recommendations included:
 - Comprehensive Focus Option + Enhanced CTE
 - Design Benson to 364,500 SF with student design capacity of 1700 (sf reductions to take place in SD)
 - Program for un-programmed space to be determined by March 2019
 - Target budget of \$296M
 - Enrollment grows gradually after construction with annual analysis of all high schools
 - PPS staff engage with MPG to discuss options to:
 - Build a dedicated MPG building
 - Remain co-located at Benson
 - Relocate to other PPS facility



December 11 BOE Meeting

- Board agenda item regarding Benson Master Plan/Ed Spec Resolution Language

Agenda & materials, can be found at PPS BOE Meeting Materials website on Friday 12/7



December 18 BOE Meeting

- Updated Benson Master Plan Report
- Benson Polytechnic Site Specific CTE Focus Option Educational Specification
- Updated Staff Report
- Updated Board Resolution

Available on PPS BOE Meeting Materials website on Friday, December 14th

MASTER PLAN UPDATE / BASSETTI ARCHITECTS

MASTER PLAN UPDATE

"The lower level is not a good place for the Wellness Clinic."

"Love the learning stairs and social courtyard!"

"Clear lines of sight in the hallways are important for supervision."

UPDATES TO PLAN SINCE LAST DAG WORKSHOP:

- + Health Clinic relocated to main floor from the lower level auditorium
- + Wrap around services including Teen parent childcare & food/clothes closet relocated from auditorium building to gym building
- + Media and Counseling areas are reconfigured
- + CTE Un-programmed areas re-located to auditorium building
- + Revisions of proportions and/or adjacencies of CTE programs including: Computer engineering, Digital Media, Manufacturing, Architecture, Engineering, and Arts
- + Increased # of Core academic classrooms to ensure adequate capacity for 1700, based on Benson Administration feedback
- + Reconfigure SPED, to smaller paired rooms and increased total from 6 to 8.
- + Flex area and teacher planning reconfiguration for closer proximity to both core academic and CTE, as well as spread out for more visibility to corridors and flex areas.

SITE PLAN

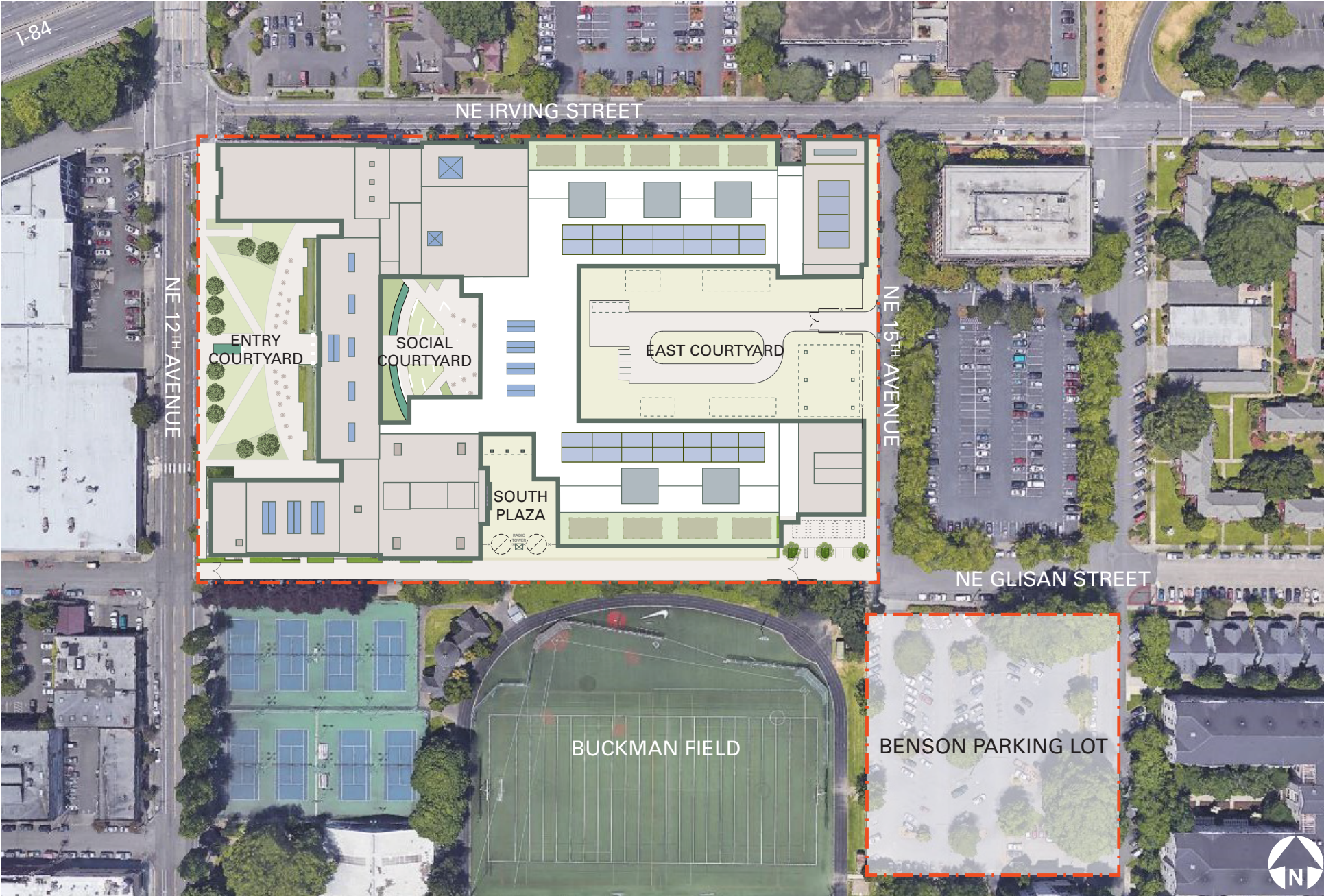

MASTER PLAN / MAIN LEVEL

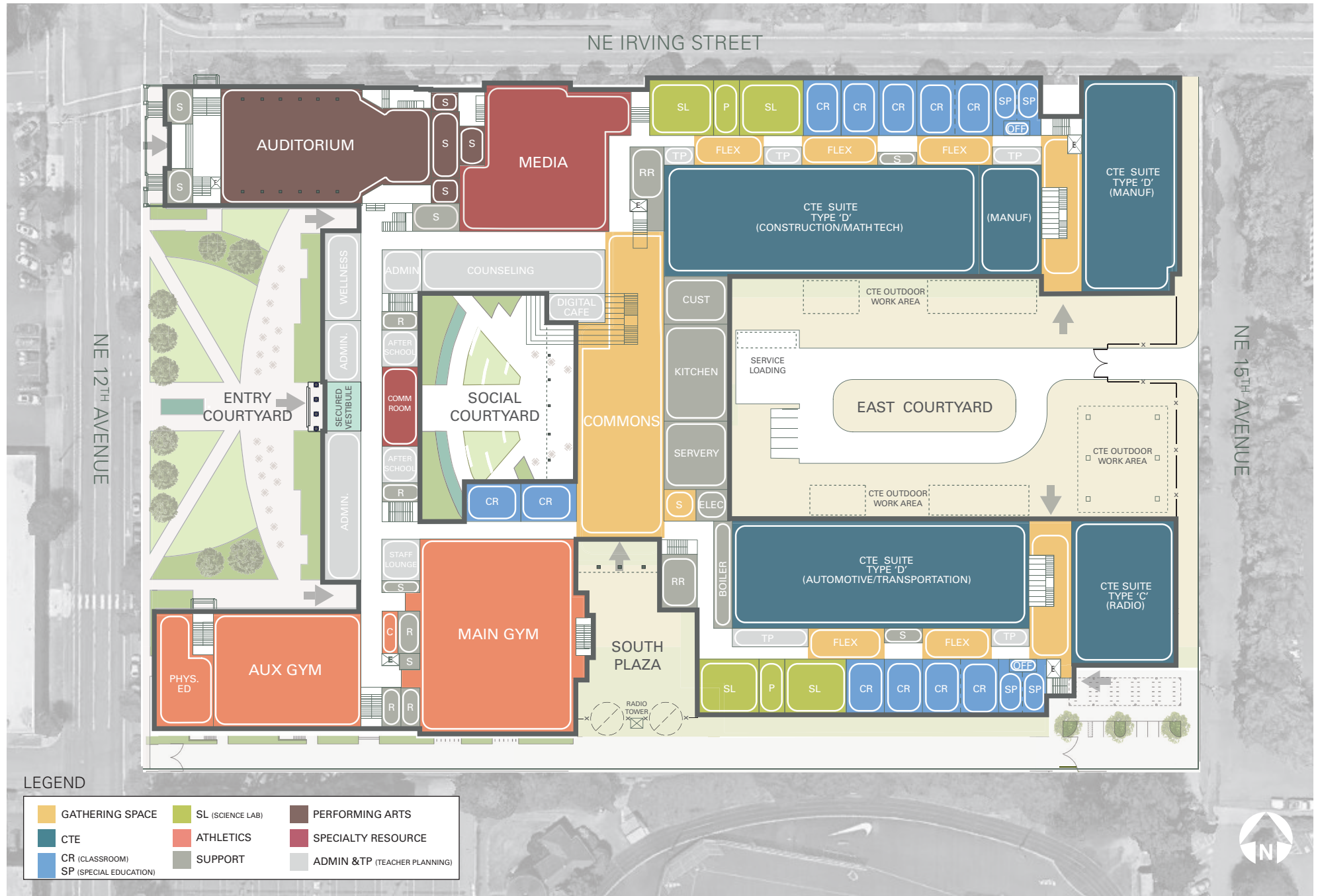

MASTER PLAN / UPPER LEVEL

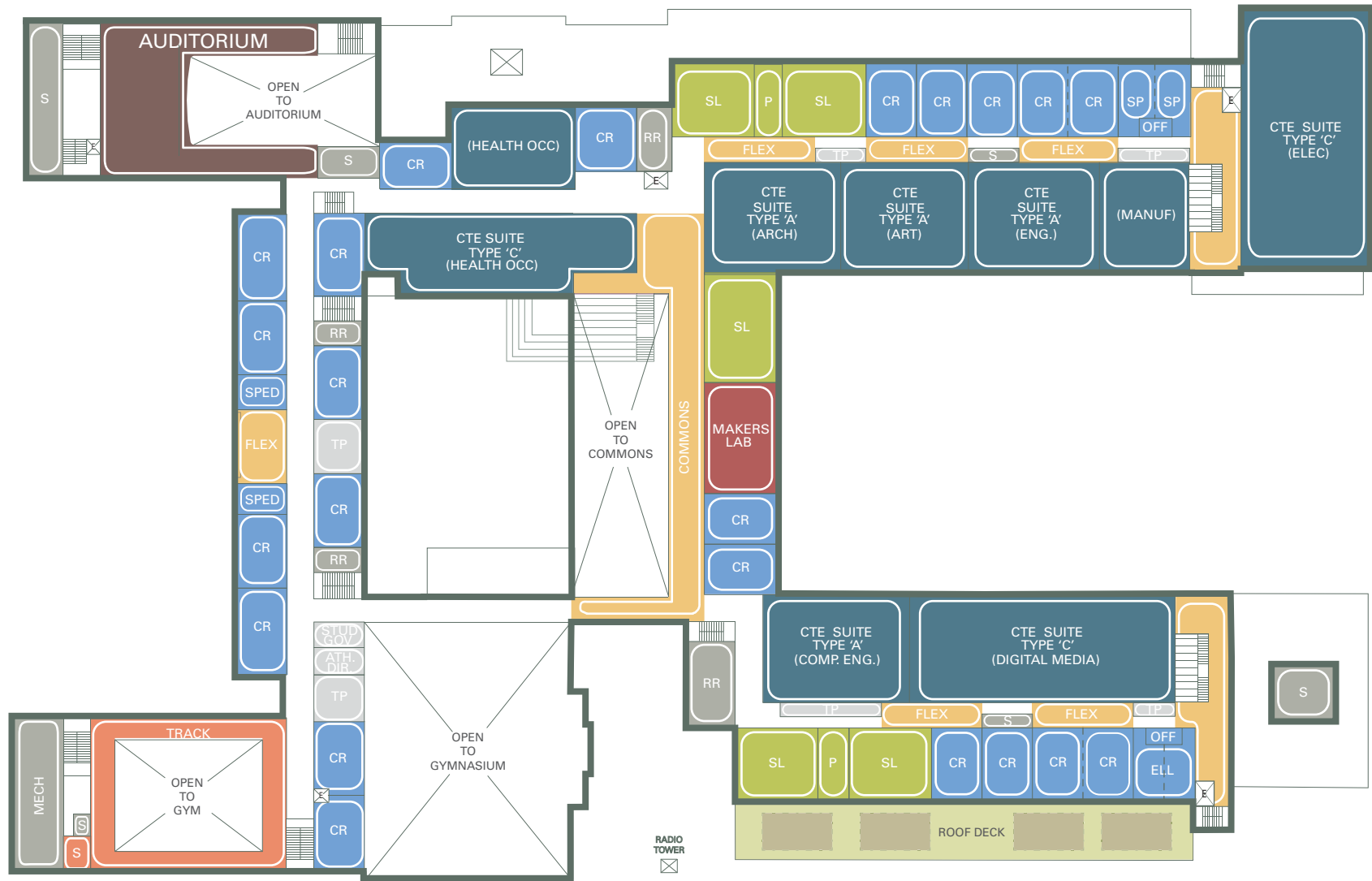

LEGEND

 GATHERING SPACE	 SL (SCIENCE LAB)	 PERFORMING ARTS
 CTE	 ATHLETICS	 SPECIALTY RESOURCE
 CR (CLASSROOM)	 SUPPORT	 ADMIN & TP (TEACHER PLANNING)
 SP (SPECIAL EDUCATION)		

MASTER PLAN / LOWER LEVEL

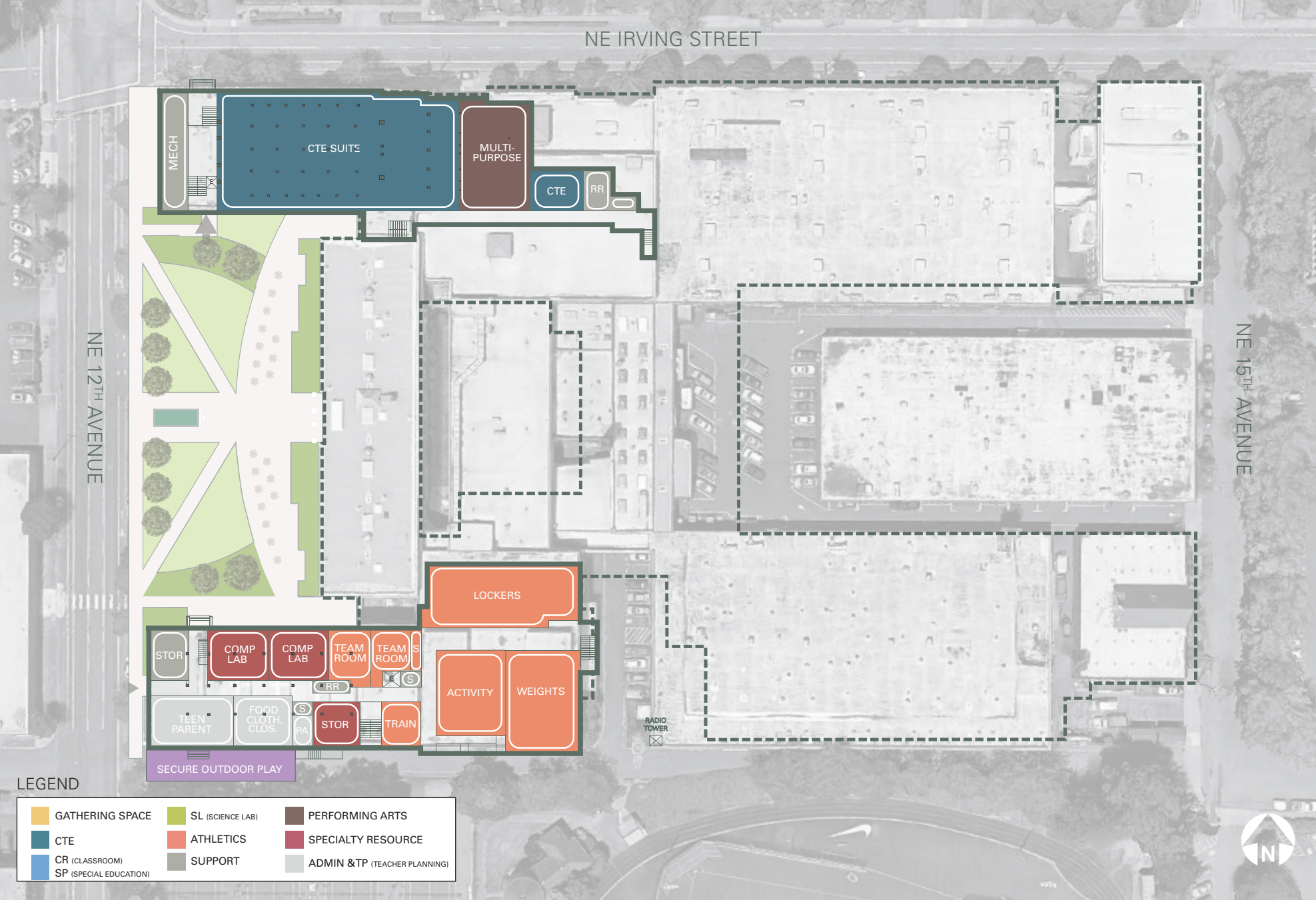

MASTER PLAN / UN-PROGRAMMED SPACE SUMMARY

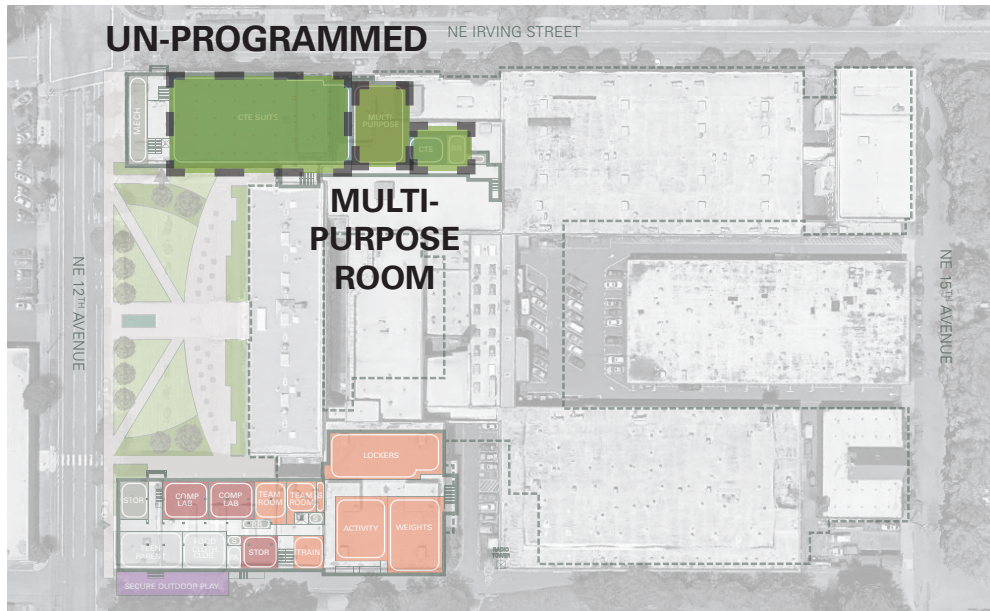

LOWER LEVEL

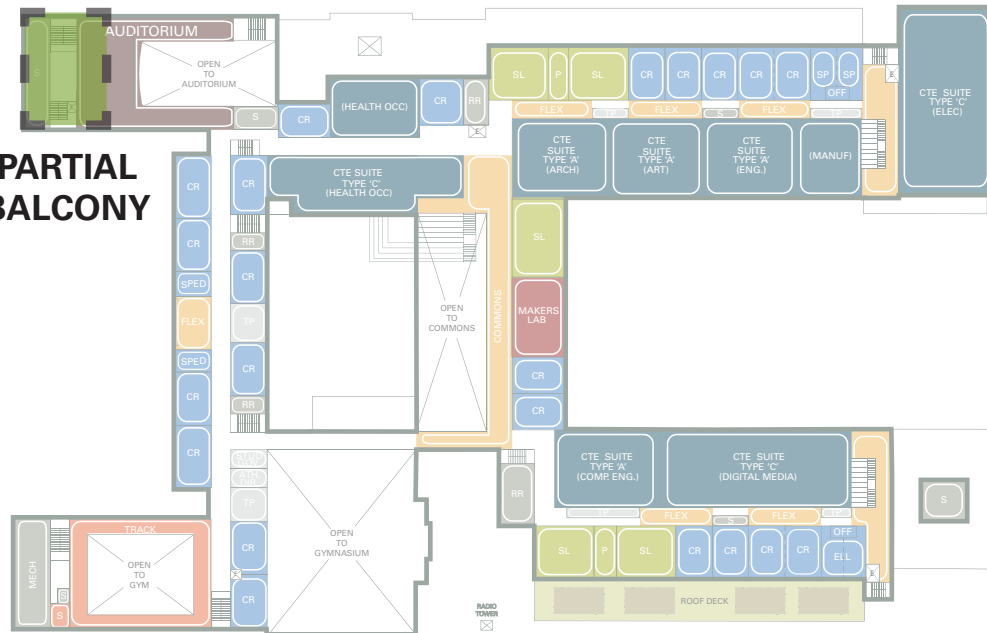

UPPER LEVEL

BENSON POLYTECHNIC HIGH SCHOOL / DAG #3(12.06.2018)

UN-PROGRAMMED OPTIONS

- + CTE SUITE(S)
- + BAND/CHOIR/MUSIC ARTS
- + MULTIPLE PATHWAYS TO GRADUATION

UN-PROGRAMMED SUMMARY

11,500 SF	LOWER LEVEL
3,500 SF	MULTI-PURPOSE
15,000 SF	TOTAL

OTHER POTENTIAL SPACES

3,000 SF	PARTIAL BALCONY CONVERSION TO PROGRAM SPACE
----------	---

SITE PLAN / SCOPE ADJUSTMENTS

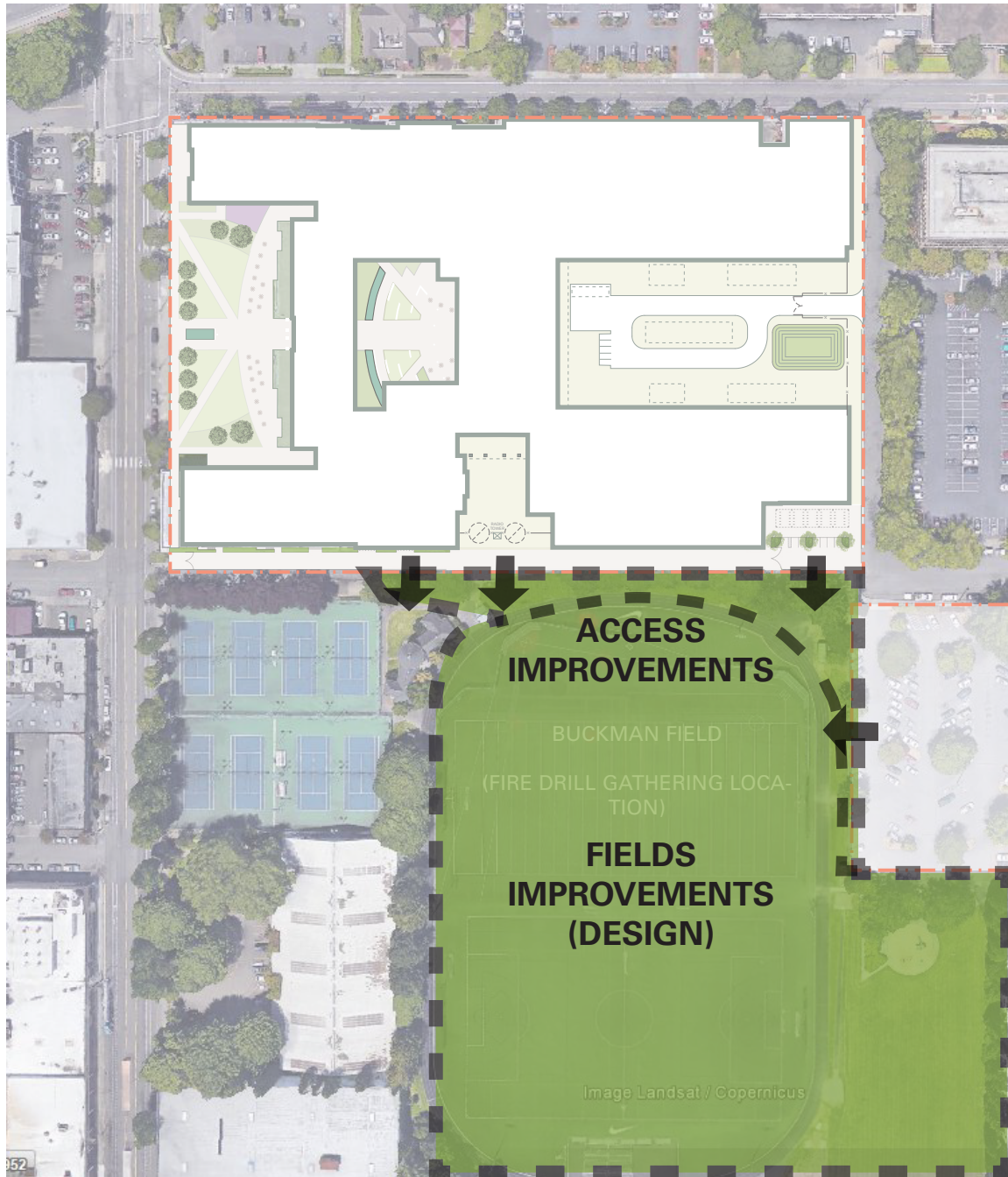

SITE DESIGN / MAYER/REED

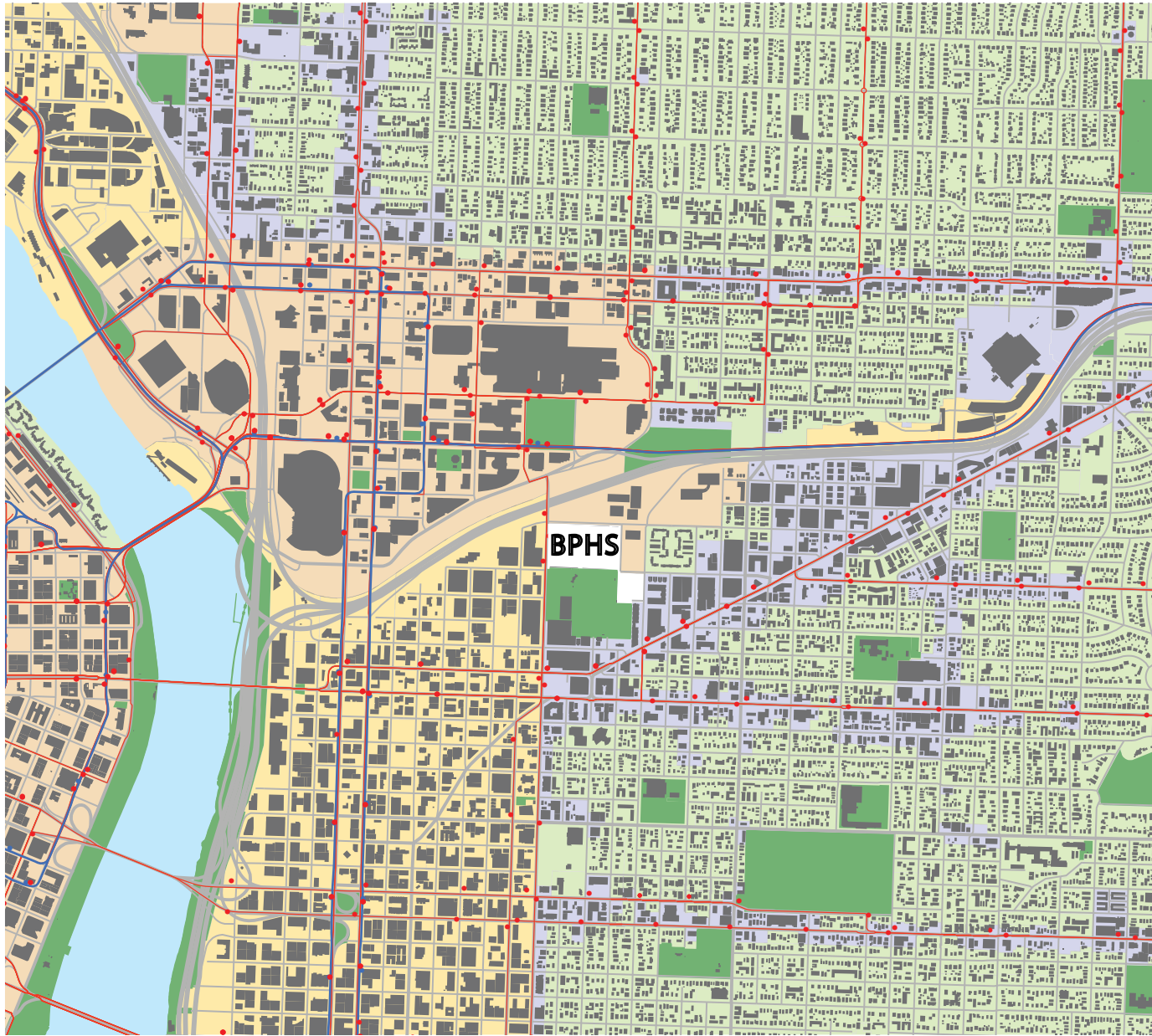

CONTEXT / ADJACENCIES AND CONNECTIONS

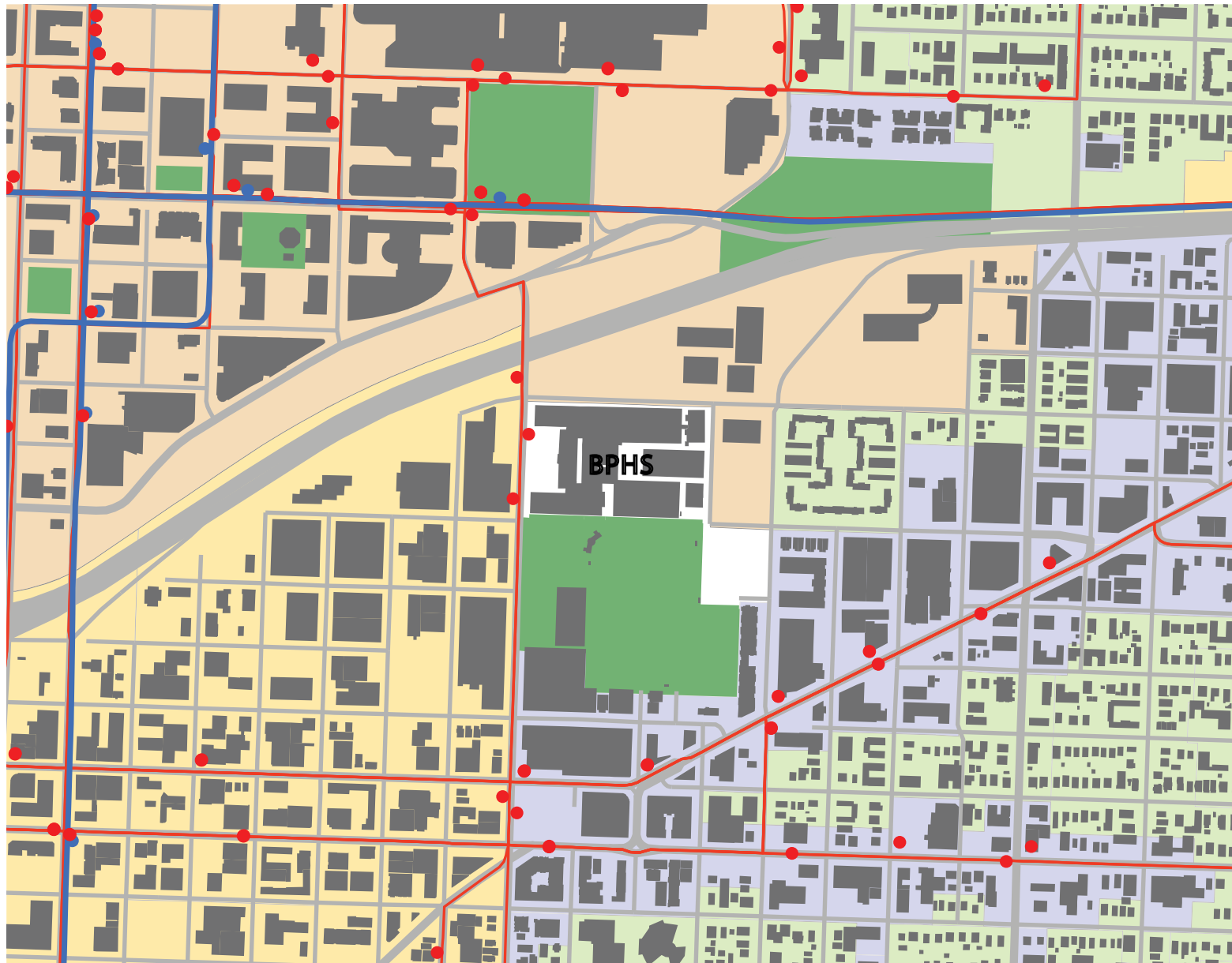

SITE / DEVELOPMENT AND THE FUTURE

EACH DOT REPRESENTS A PROJECT IN DEVELOPMENT :: COLORS = PHASE :: MAJORITY RESIDENTIAL PROJECTS

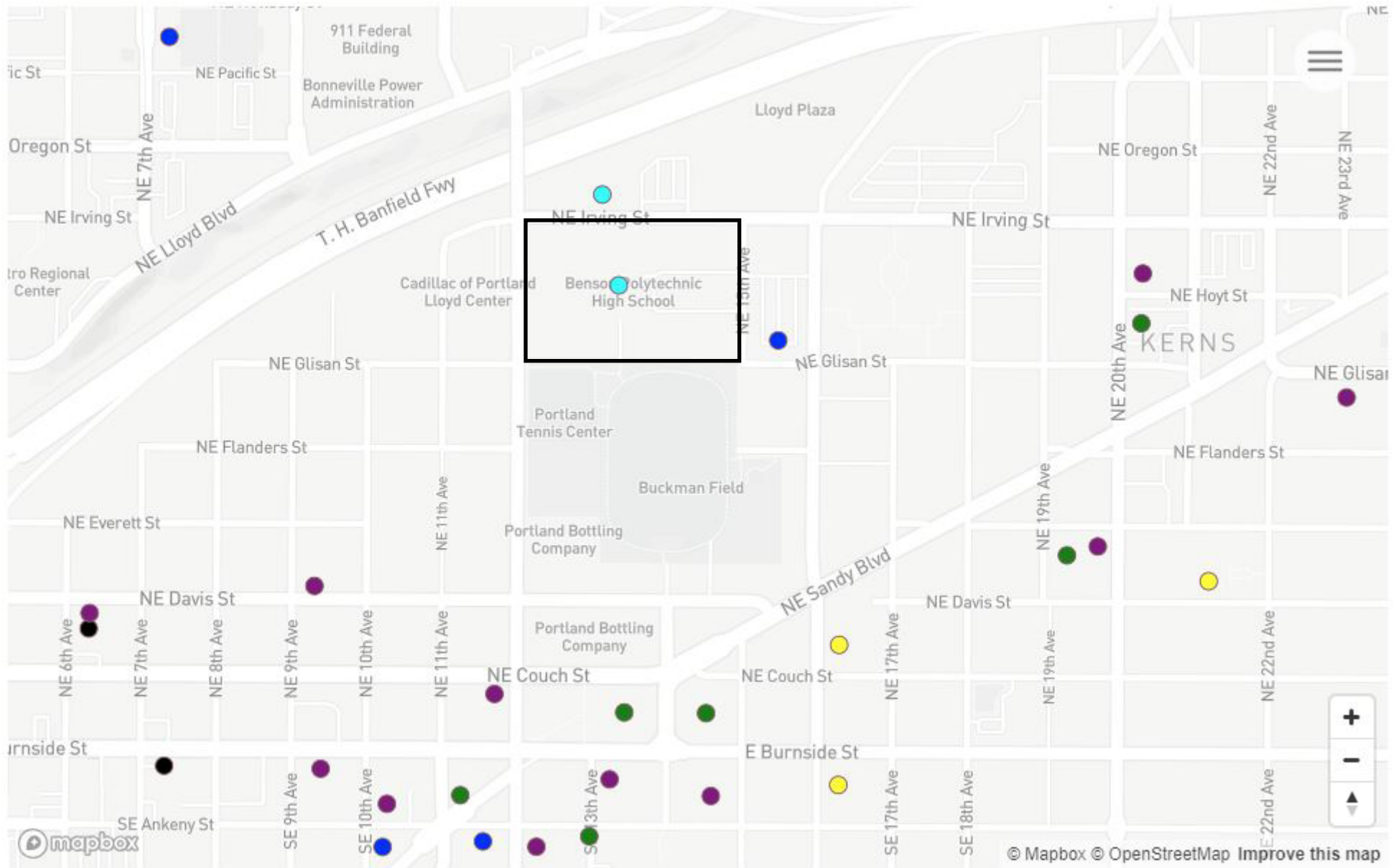

WWW.NEXTPORTLAND.COM

SITE / MASTERPLAN

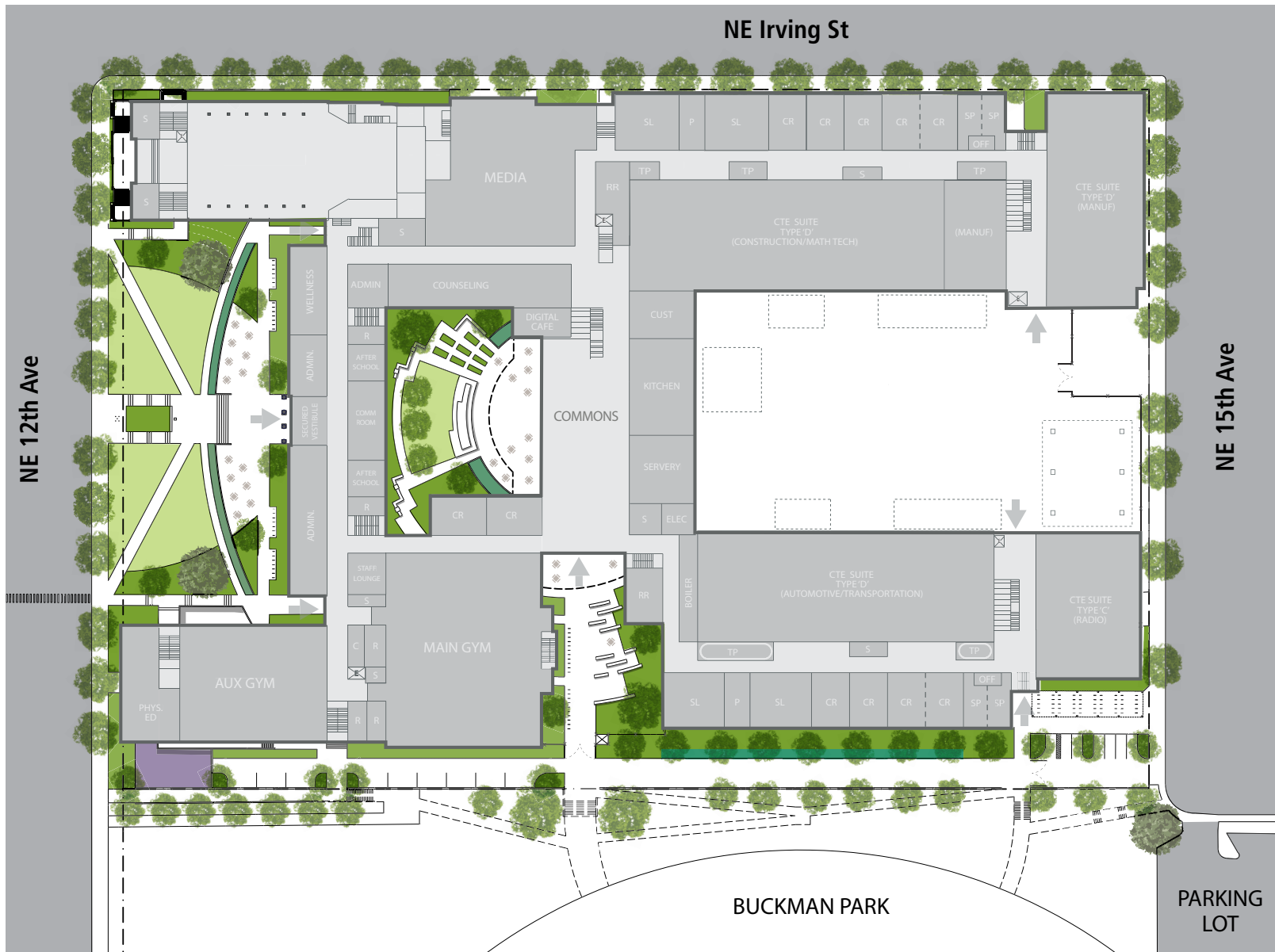

SITE / ZONES

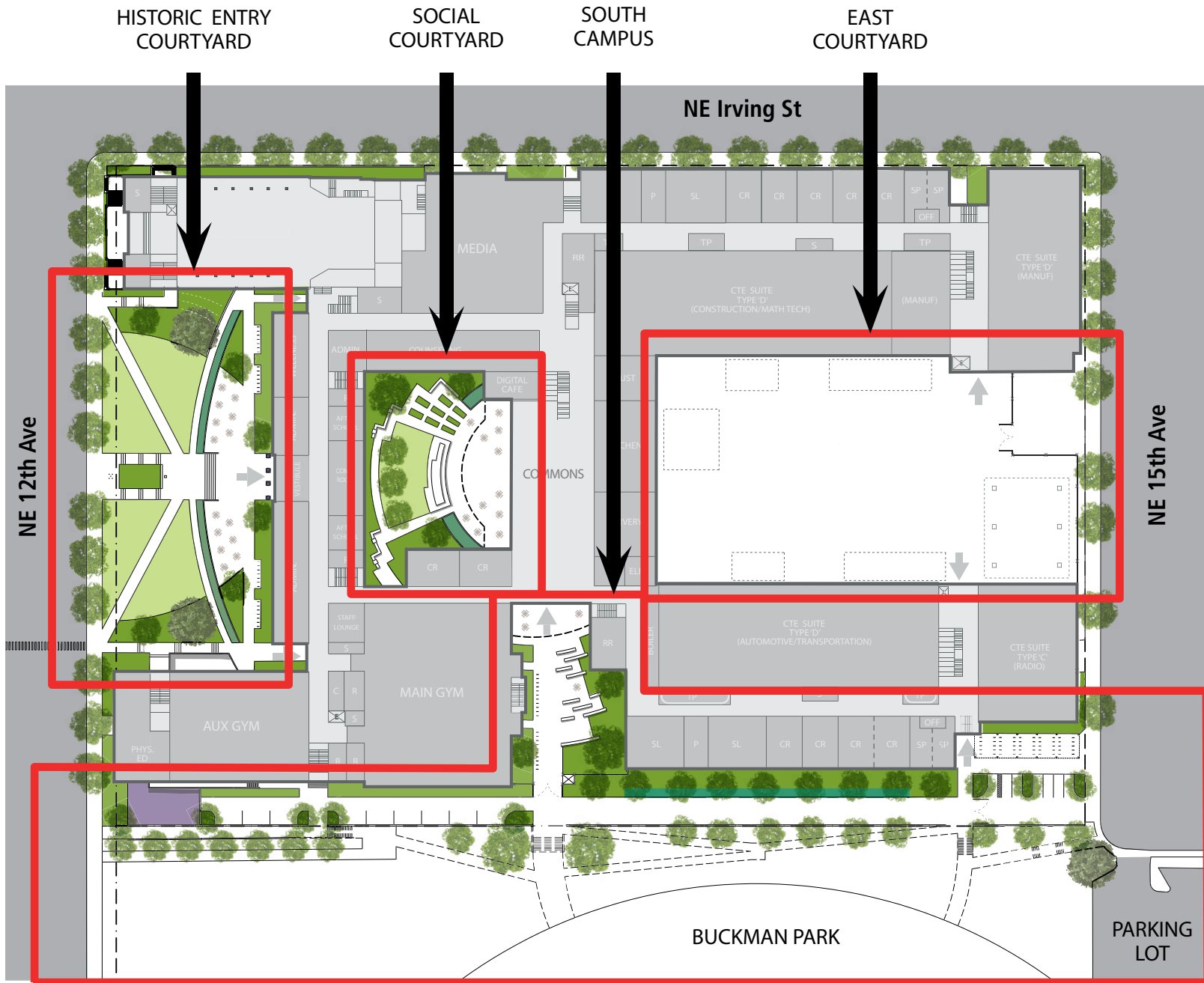

HISTORIC FRONT ENTRY / GUIDING PRINCIPLES

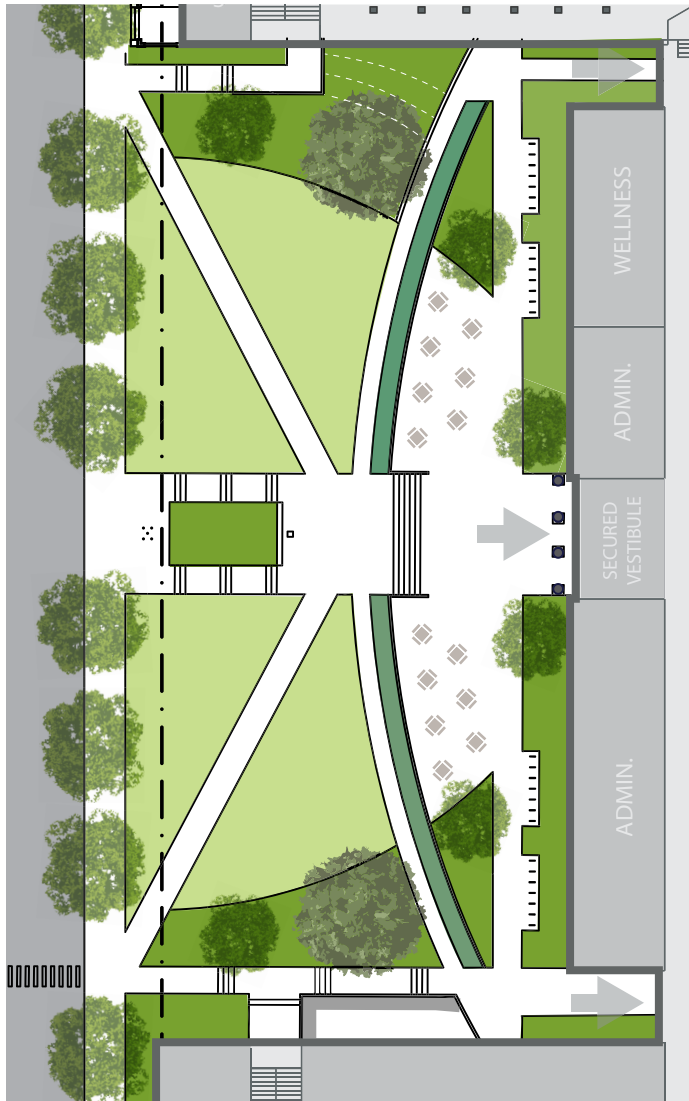

APPLICABLE GUIDING PRINCIPLES

- + Honor the unique history and culture of Benson Polytechnic High School.
- + Provide learning environments that inspire creativity and collaboration among students.
- + Celebrate diversity and provide a sense of inclusion and belonging among students and families.

HISTORIC FRONT ENTRY / PROGRAMMING

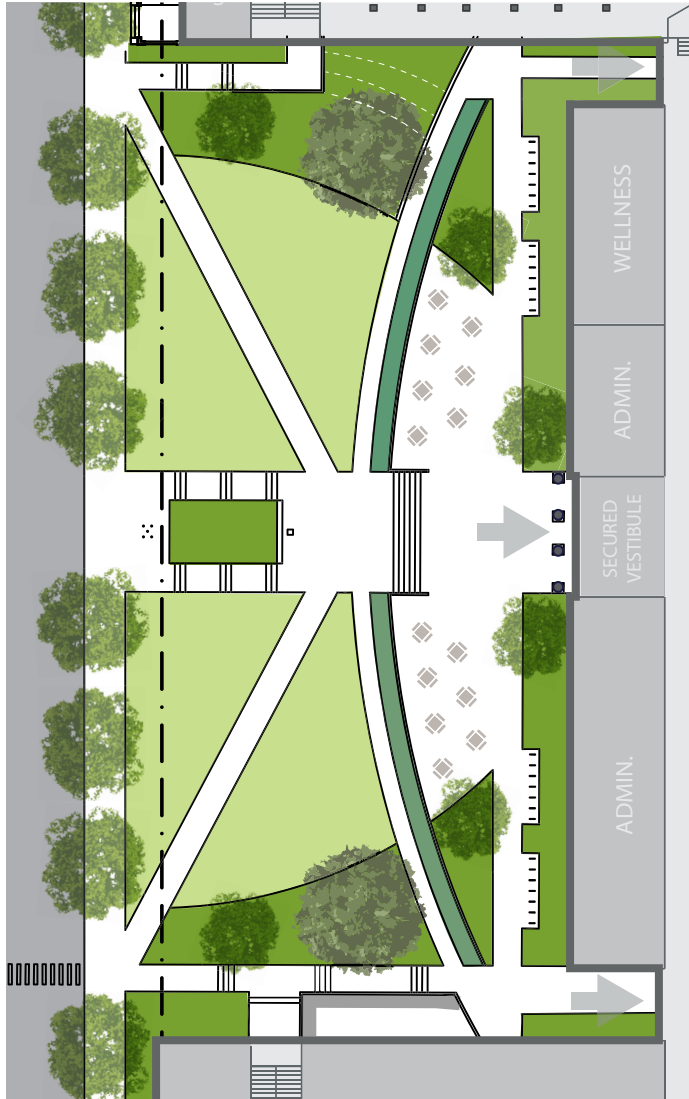

YOUR INPUT :: QUESTIONS, CONCERNS, IMPROVEMENTS

- + overlooked connections / access requirements
- + other issues

SOCIAL COURTYARD / GUIDING PRINCIPLES

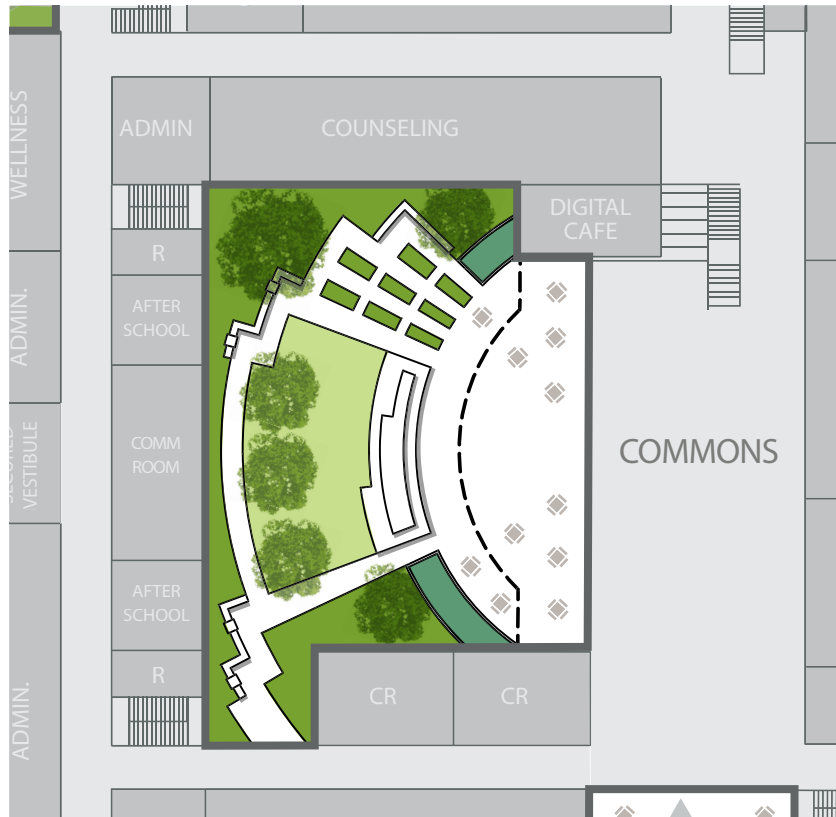

APPLICABLE GUIDING PRINCIPLES

- + Honor the unique history and culture of Benson Polytechnic High School
- + Provide learning environments that inspire creativity and collaboration among students
- + Provide agile, flexible, and adaptable facilities that support changing education and industry needs
- + Provide hands-on, project-based learning opportunities that are imbued with rigor and relevancy
- + Provide learning environments that inspire creativity and collaboration among students
- + Celebrate diversity and provide a sense of inclusion and belonging among students and families

SOCIAL COURTYARD / PROGRAMMING

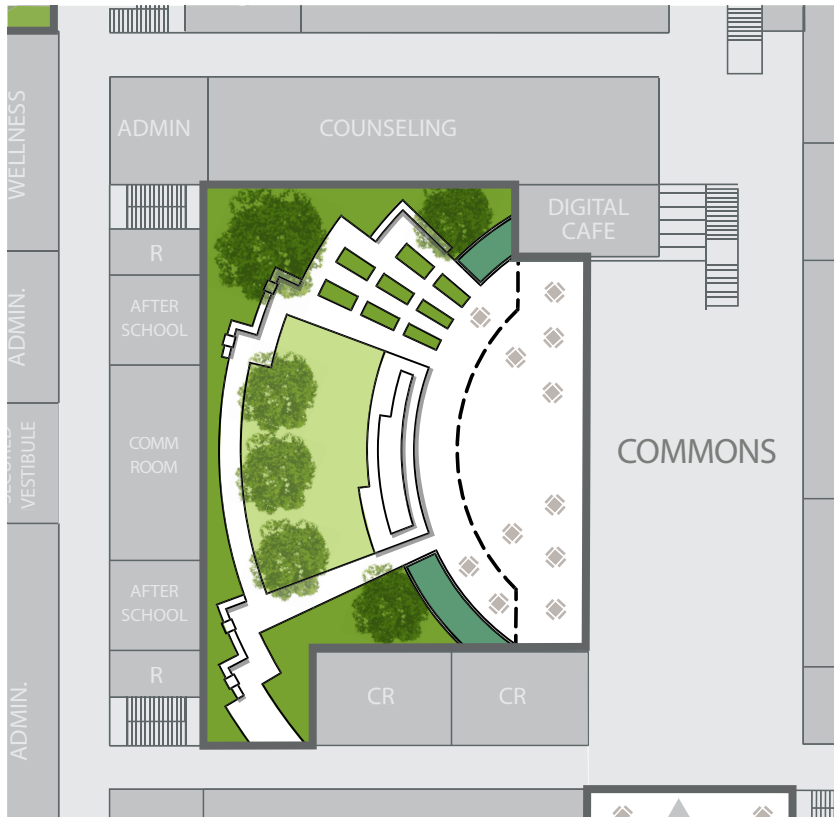

YOUR INPUT :: WHAT SHOULD IT BE, WHAT COULD IT BE?

PROGRAMS

- + Outdoor dining
- + Outdoor classrooms
- + Gatherings: large, medium, small
- + Gardening: vegetable, medicinal, flowers
- + Sustainable initiatives: stormwater, solar access, composting
- + Performance / presentations
- + Exhibit / display areas
- + Recreation / movement
- + Habitat
- + Biophilia

EAST COURTYARD / GUIDING PRINCIPLES

APPLICABLE GUIDING PRINCIPLES

- + Honor the unique history and culture of Benson Polytechnic High School.
- + Engage with the local business, government, and post-secondary partners to create strong connections between education and industry.
- + Provide learning environments that inspire creativity and collaboration among students.
- + Provide agile, flexible, and adaptable facilities that support changing education and industry needs.
- + Provide hands-on, project-based learning opportunities that are imbued with rigor and relevancy.
- + Position Benson Polytechnic as the national model for steam and career technical education.
- + Provide learning environments that inspire creativity and collaboration among students.
- + Celebrate diversity and provide a sense of inclusion and belonging among students and families.

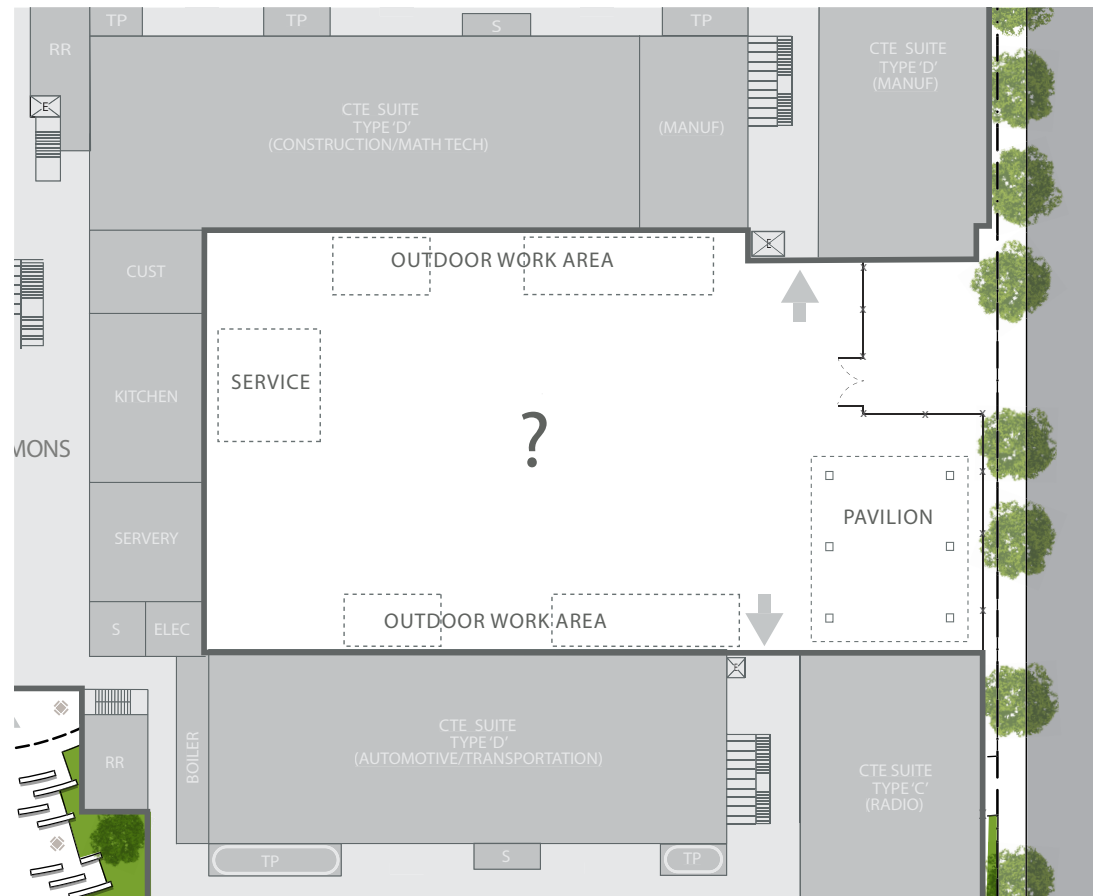

EAST COURTYARD / PROGRAMMING

YOUR INPUT :: WHAT SHOULD IT BE,
WHAT COULD IT BE?

FUNCTIONS

- + Service access :: turning radii, adequate dimensions and surfacing
- + Storage :: materials, vehicles, tiny houses
- + Outdoor work areas :: covered? fenced? who needs them? how big?
- + Service vehicle parking
- + Pedestrian safety

WHAT ELSE?

- + Exhibit / Display
- + Competitions / Presentations
- + Markets :: farmer's, Christmas trees, student wares
- + Community Connections :: master classes, local professional visits, students teaching community
- + Habitat
- + Recreation



SOUTH CAMPUS / GUIDING PRINCIPLES

APPLICABLE GUIDING PRINCIPLES

- + Honor the unique history and culture of Benson Polytechnic High School.
- + Provide learning environments that inspire creativity and collaboration among students.
- + Provide agile, flexible, and adaptable facilities that support changing education and industry needs.
- + Provide learning environments that inspire creativity and collaboration among students.
- + Celebrate diversity and provide a sense of inclusion and belonging among students and families.



SOUTH CAMPUS / PROGRAMMING

YOUR INPUT :: WHAT SHOULD IT BE, WHAT COULD IT BE?

FUNCTIONS

- + Fire truck access
- + Pedestrian connections :: safe, adequately sized, ADA compatible
- + Parking :: limited vehicular, covered bike
- + Radio tower :: respect (historic/culture and human safety)

WHAT ELSE?

- + Sustainability
- + Habitat
- + Benson Tech school spirit facing athletics facilities
- + Security :: how much? where? for whom?



UPDATED MASTER PLAN ACTIVITY /

60 min

Activity

- +Breakout into 6 groups of about 7 people each
- +Provide input on proposed masterplan and site updates
- +What is working, what can be improved?
- +How this is responding to aspects identified on existing site from first worksession?
- +Don't be afraid to write, post, or markup the diagrams!
- +Rotate and visit each station at 10 minute intervals

15 min

Student Report Back / Discussion

STUDENT REPORT BACK / 15 MINUTES

PUBLIC COMMENT / 10 MINUTES

THANK YOU. / NEXT MEETING: JANUARY 31 @ 6:00PM